

Removing the Bb Thumb Key

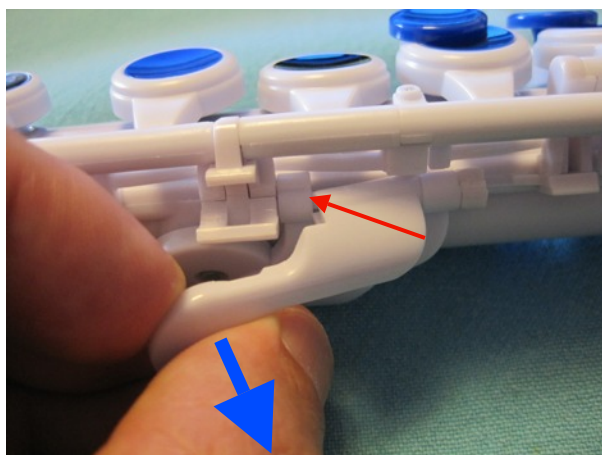

First remove the long trill key from the instrument as shown previously. Now take hold of the Bb thumb key firmly between the thumb and forefinger. Pull sharply towards you so that the left hand end indicated by the red arrow becomes disengaged from its pivot.

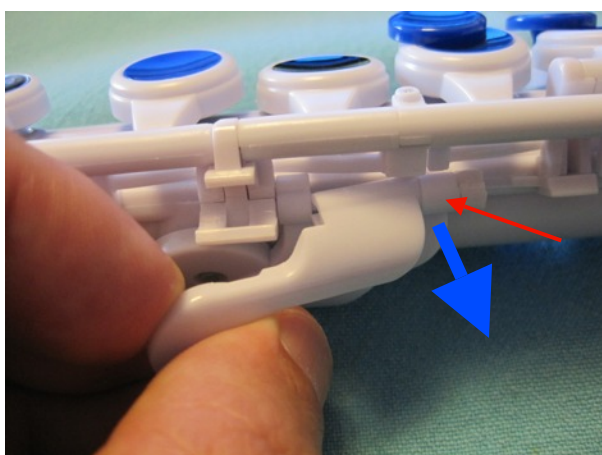

Now disengage the right hand pivot.

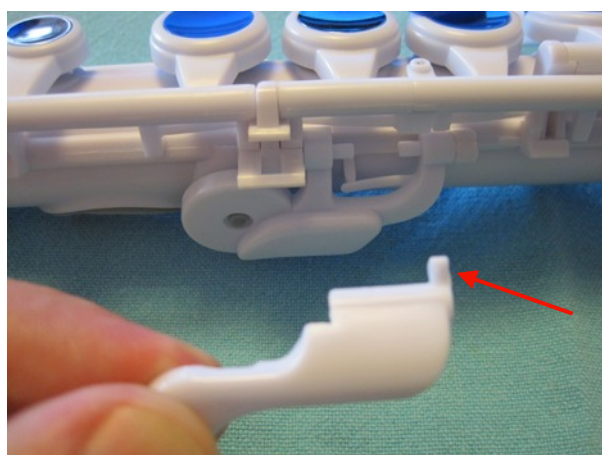

Notice the projection which activates the Bb key. Check that it has not become distorted or broken off.

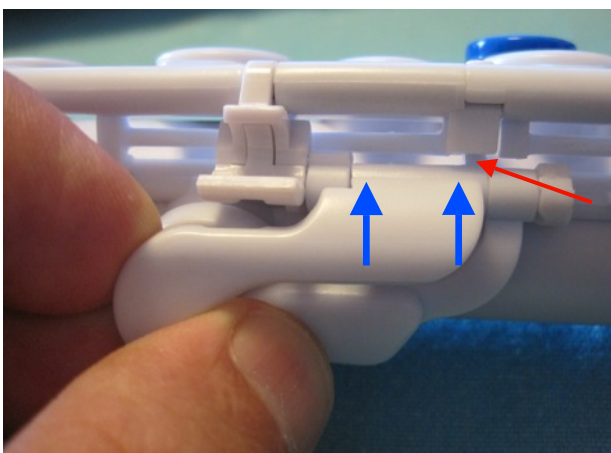

To re-assemble, make sure the projection is positioned correctly behind the spring base on the Bb key as shown. Now push sharply back into position as indicated by the two blue arrows. .